

Connah's Quay Low Carbon Power

Environmental Statement Volume III Figure 8-4: Air Quality Study Area – FEED 1 Modelled Buildings

Planning Inspectorate Reference: EN010166
Document Reference: EN010166/APP/6.3
Planning Act 2008 (as amended)
Infrastructure Planning (Applications: Prescribed Forms and Procedure) Regulations
2009 - Regulation 5(2)(a)
Revision 01

March 2026

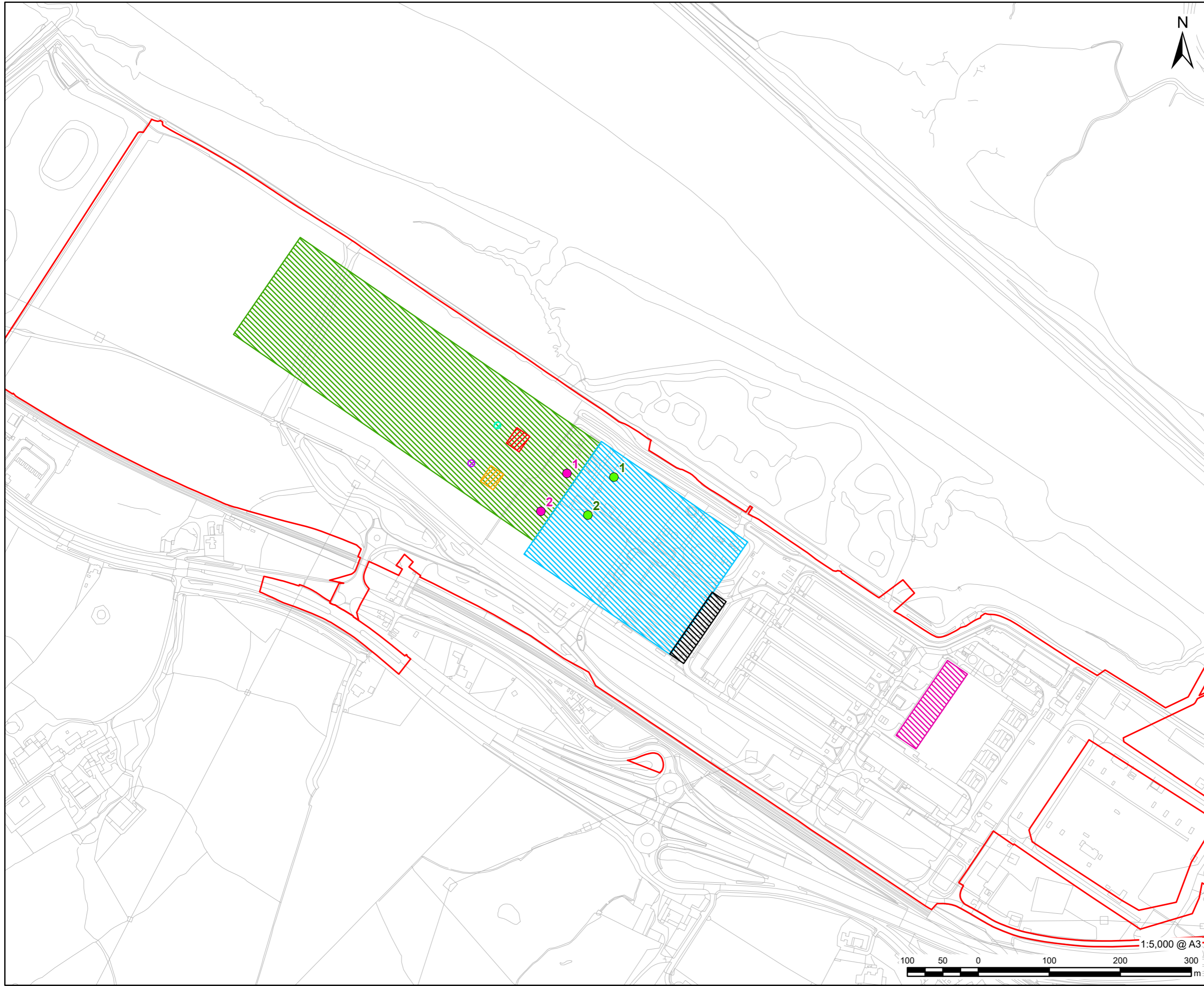

LEGEND

	Order limits
	Feed 1 - Absorber Stack
	Feed 1 - Bypass Stack
	1A CCGT Buildings
	1C Admin Building
	1F Cooling and CO ₂ Compression Infrastructure
	Train 1 Absorber
	Train 1 Stripper
	Train 2 Absorber
	Train 2 Stripper
	Boiler House

NOTES

Air Quality Study Area(s), including for specific receptors shown, defined in Section 8.4 of Chapter 8: Air Quality (ES Volume II). Figure is scaled to appropriately show the buildings included in the model for the assessment, including those of the Proposed Development, rather than whole Order limits (Excluding the Accommodation Work Areas). © Crown Copyright 2025. All rights reserved. Ordnance Survey Licence AC0000808122.

ISSUE PURPOSE
Environmental Statement

DATE
March 2026

PROJECT NUMBER
60768754

FIGURE TITLE
Air Quality Study Area – FEED 1 Modelled Buildings

FIGURE NUMBER
Figure 8-4

This drawing has been prepared for the use of AECOM's client. It may not be used, modified, reproduced or relied upon by third parties, except as agreed by AECOM or as required by law. AECOM accepts no responsibility, and denies any liability whatsoever, to any party that uses or relies on this drawing without AECOM's express written consent. Do not scale this document. All measurements must be obtained from the stated dimensions.

